

Follow these steps to add employees your NJPMA.com Company Profile

1. Log-in to your NJPMA.com Account. If you forgot your password, or never created a log-in to NJPMA.com, click on the "Forgot Password" link and input your email address. A log-in creation/re-set email will be send to you.

Account Login

Login Name:

Password:

[Forgot Password?](#)

Remember me for 2 weeks.

Log In

[Create an account](#)

2. Once you have logged-in, click on "+ / - Employees Button" from the Navigation options.

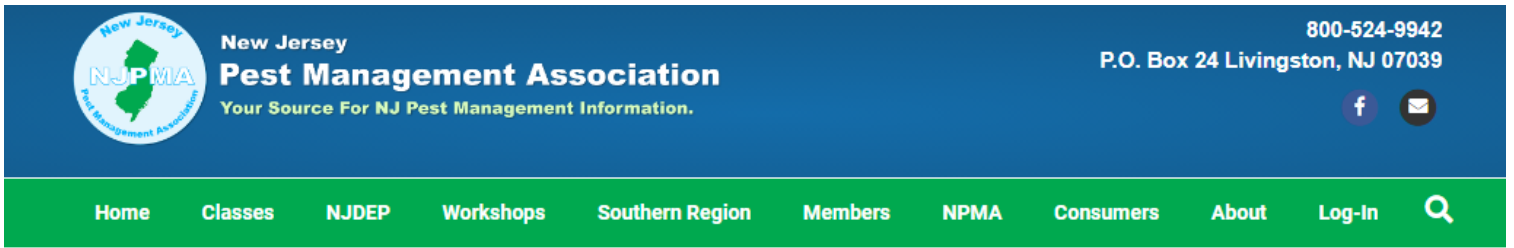

Welcome Mickey Mouse Pest Control (Account# 1905)

Your membership is currently active. [Details](#)

**Welcome to the NJPMA
Member Portal**

MEMBER CONTENT

Here you will find resources Exclusive to you and your fellow NJPMA Members.
Click on the Squares Below to Make Your Selection.

What would you like to do?

- [NJPMA Member Portal](#)
- [My Membership](#)
- [Change Password](#)
- [Update My Profile](#)
- [Current NJPMA Classes & Workshops](#)
- [My Registered Events](#)
- [NJPMA Member Directory](#)
- [NJPMA Email Lists](#)
- [Login Home](#)
- [Log out](#)

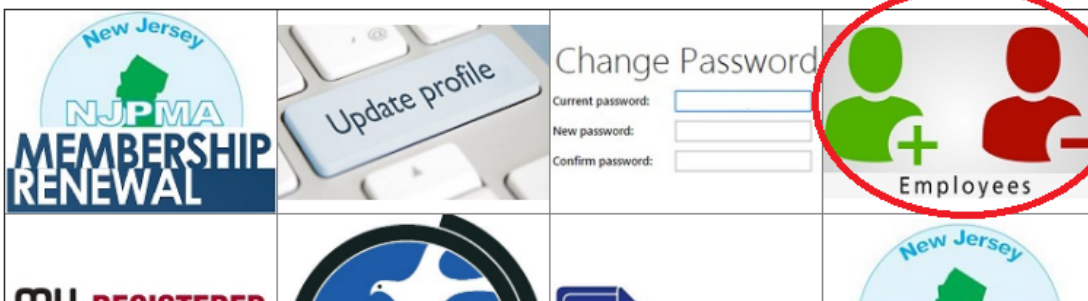

CLICK HERE

Once in your account, look under "**Membership History**". You will find the "**Add Contact**" link. Fill out the Registration form completely with only the Employees Information.

Welcome Mickey Mouse Pest Control (Account# 1905)

Your membership is currently active. [Details](#)

Membership History

Current Membership

Your Membership is currently active.

Membership	Start Date	End Date	Amount	Auto-Renewal	#
Out of state	05/01/2018	06/30/2019	\$0.00	Off - Enable	

Membership History

Membership	Start Date	End Date	Amount	Status	Trans:
Out of state	05/01/2018	06/30/2019	\$0.00	SUCCEED	Detail

Additional Sub Members & Memberships

Contacts: [Add](#) [Remove](#) Sub-Membership: [Join](#) [Renew](#)

Action Member Membership Fee Start Date End Date

What would you like to do?

- [Update My Profile](#)
- [Current Events](#)
- [Setup My Login](#)
- [My Membership](#)
- [My Registered Event](#)
- [NJPMA Member Directory](#)
- [Re-Subscribe Email](#)
- [NJPMA Member Mail](#)
- [Login Home](#)
- [Log out](#)

Please fill out the top of this form with your business info, *not* your employees home address.

Business Information:

Gross Annual Sales - Over \$10 Million - Please contact the NJPMA

Membership:

Employee

Company: *

Mickey Mouse Pest Control

Business Address *

1600 Buena Vista Blvd

City: *

Buena Vista

State: *

New Jersey

Zip: *

08234

-

Phone *

800-MickeyM

Email: *

Mickey@MMouse.com

The membership you have selected will automatically renew.

If you would like to manage your NJPMA.com account (i.e., view and print history, update profile, etc.), please create a login name and password below. Your password must be at least eight characters long, and contain at least one number.

Please ignore that it says Owner / Principle Information here.

This is actually your employee's info!

Owner / Principle Information:

First Name *

Scrooge

Last Name: *

McDuck

Title:

Tech

Log-in Information:

Create a Login Name: *

Scrooge1

Password: *

●●●●●●●●

Retype Password: *

●●●●●●●●

Start Date:

05/01/2018

(MM/dd/yyyy)

End Date:

06/30/2019

(MM/dd/yyyy)

Remember in order for your employee to properly receive Credits with the NJDEP, we MUST have their correct, Date of Birth, Last Four of Social Security #, and Applicator Licence # (please NOT Operator or Business License #'s). If your employee does not yet have an Applicator License, please type "NONE".

NJ Pesticide Applicator License # *

23456B

Last 4 Digits of Individuals Social Security Number *

1234

Date of Birth *

04/15/1980



Add Another Sub-member

Previous

Continue

Click Continue, and you are done.

Once in the system, your employee will now be available to register for events and classes, and to take advantage of NJPMA Member discounts when available.

Remember to log in to get NJPMA Member Discounts on Basic Pesticide Training / CORE Classes, or any of our Seminars and The Clinic, Trade Show and Clambake.

Membership has its benefits!